

# WorkForce WF-3620DWF



## DATASHEET



This Wi-Fi and Ethernet business printer is the perfect way to increase office productivity and simultaneously reduce printing costs. It features fast business-quality printing of up to 19ppm<sup>1</sup>, front-loading paper tray and 8.8cm touch-screen, as well as a high yield XXL black ink that delivers approximately 2,200 pages<sup>2</sup>.

### A4 duplex 4-in-1

This model comes with a 35-sheet automatic document feeder and offers duplex print, scan, copy and fax functions. In addition to the front loading paper tray, the rear speciality paper path means you can print on a wide range of thicker paper, envelopes or labels to suit your business needs.

### Mobile printing

Epson Connect<sup>3</sup> allows you to print important office documents from smartphones and tablets. You can also print from anywhere in the world by emailing files directly to the printer, and store scanned documents in cloud services. In addition, this printer is also Google Cloud Print and Apple AirPrint compatible. For added versatility, Wi-Fi Direct™ allows easy printing from wireless devices without having to connect to a wireless router.

### New printhead

PrecisionCore, Epson's most advanced printhead technology, powers the industry-leading output quality and durability that Epson is renowned for, at the high speeds required for office, commercial and industrial printing.

### Durable ink

Epson's DURABrite Ultra Ink is ideal for producing laser-like business documents. Documents are water, smudge and highlighter resistant, while its quick-drying properties make it perfect for duplex printing. Available in 27XXL, 27XL and standard sizes, these high-capacity, individual ink cartridges offer great savings, with a 50% lower cost-per-page than competitive lasers<sup>4</sup>.

## KEY FEATURES

- **A4 4-in-1**  
Duplex print, scan, copy and fax
- **Fast print speeds**  
Business-quality 19ppm printing<sup>1</sup>
- **Connectivity**  
Wi-Fi, Wi-Fi Direct and Ethernet
- **Front paper tray**  
250-sheet capacity
- **Epson Connect**  
Freedom to print and scan anywhere

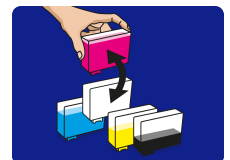

## PRODUCT SPECIFICATIONS

### TECHNOLOGY

Printing Method	PrecisionCore™ Print Head
Minimum Droplet Size	2.8 pl, With Variable-Sized Droplet Technology
Ink Technology	DURABrite™ Ultra

### PRINT

Printing Speed ISO/IEC 24734	19 Pages/min Monochrome, 10 Pages/min Color
Maximum Printing Speed	20 Pages/min Color (plain paper), 33 Pages/min Monochrome (plain paper)
Duplex Printing Speed	9.2 A4 Pages/min Monochrome, 6.3 A4 Pages/min Color
ISO/IEC 24734	
Printing Resolution	4,800 x 2,400 dpi
Max Duty cycle	20,000 Pages per month
Colours	Magenta, Yellow, Cyan, Black

For detailed information on printing speeds please visit <http://www.epson.eu/testing>.

### SCAN

Scanning Resolution	1,200 dpi x 2,400 dpi (Horizontal x Vertical)
Output formats	BMP, JPEG, TIFF, PDF, searchable PDF
Scanner type	Contact image sensor (CIS)

### FAX

Fax speed dials (max)	100 names and numbers
Page memory	Up to 180 pages (ITU-T No.1 chart)
Fax Functions	Favorites, PC Fax, Auto Redial, Speed Dial

### PAPER / MEDIA HANDLING

Paper Formats	A4, A5, A6, B5, C4 (Envelope), C6 (Envelope), DL (Envelope), No. 10 (Envelope), Letter, 10 x 15 cm, 13 x 18 cm, 16:9, User defined, Legal
Automatic Document Feeder	35 Pages
Duplex	Yes
Paper Tray Capacity	250 Sheets Standard, 250 Sheets maximum
Number of paper trays	1

### CONNECTIVITY

WLAN Security	WEP 64 Bit, WEP 128 Bit, WPA PSK (TKIP), WPA PSK (AES)
---------------	--

### OTHER

Warranty	12 months Carry in Optional warranty extension available
----------	---

## LOGISTICS INFORMATION

SKU	C11CD19302
Barcode	8715946529653
Dimensions Single Carton	525 x 485 x 327 mm
Carton Weight	11.85 Kg
Multiple Order Quantity	1 Units
Country of Origin	Indonesia
Pallet Size Euro	12 Units (2 x 6)



\* Warranty offers are not available for all countries. Please contact your local Epson representative.

For further information please contact your local Epson office or visit [www.epson-europe.com](http://www.epson-europe.com)  
 Austria 01 253 49 78 333 Belgium +32 (0)2 792 04 47 Czech 800/142 052 Denmark 44 50 85 85 Finland 0201 552 091 France 09 74 75 04 04  
 (Cost of local call, operator charges may apply) Germany +49 (0) 2159/92 79 500 Greece 210-8099499 Hungary 06800 147 83  
 Ireland 01 436 7742  
 Italy 02-660321 10 (0,12 /min) Luxembourg +352 27860692 Middle East +9714 8872172 Netherlands +31 (0)20 708 5099 Norway  
 +47 67 11 37 00 Poland 0-0-800 4911299 (0,16 zł/min) Portugal 707 222 111 Russia (095) 777-03-55 Slovakia 0850 111 429  
 South Africa (+2711) 465-9621  
 Spain 93 582 15 00 Sweden 0771-400135 (Mobilsamtal – 0,99 kr/min, Lokala samtal – 0,30 kr/min, Utlandssamtal – 0,89 kr/min)  
 Switzerland 022 592 7923 Turkey (0212) 3360303 United Kingdom 0871 222 6702

Trademarks and registered trademarks are the property of Seiko Epson Corporation or their respective owners. Product information is subject to change without prior notice.

## WorkForce WF-3620DWF

### WHAT'S IN THE BOX

- CD Manual
- Power cable
- Main unit
- Warranty document
- Individual Ink Cartridges
- Software (CD)
- Driver and utilities (CD)
- Quick Start Guide

### INK CARTRIDGE COMPATIBILITY



### INK YIELD DATA

	Alarm clock 27XL	Alarm clock 27XXL	Alarm clock 27
Black	1,100 pages*	2,200 pages*	350 pages*
Cyan, Magenta, Yellow	1,100 pages*		300 pages*

\* Approx. page yield based on ISO/IEC 24711/24712 or ISO/IEC 29102/29103. Actual yield will vary depending on images printed and usage conditions. For more information visit <http://www.epson.eu/pageyield>

1. - Determined in accordance with ISO/IEC 24734 showing the average of ESAT from the Office Category Test for default A4 simplex and duplex. For more information, please visit [www.epson.eu/testing](http://www.epson.eu/testing) 2 - Approx. page yield based on ISO/IEC 24711/24712. Actual yield will vary depending on images printed and usage conditions. For more information visit [www.epson.eu/pageyield](http://www.epson.eu/pageyield) 3 - Epson iPrint requires a wireless connection and the Epson printing app. Epson Email print, Epson Remote Print Driver and Epson Scan-to-Cloud require a connection to the internet. For more information, supported languages and devices, please visit [www.epsonconnect.eu](http://www.epsonconnect.eu) 4 - For more information, please visit [www.epson.eu/inkjetsaving](http://www.epson.eu/inkjetsaving)

**EPSON**®